



SWING CHECK VALVE DN100 PN16

60-00000040
304622

DESCRIPTION: RG5 body swing check valve with metal sealing.
Screwed cover. Flat face flanges.

STANDARD & DESIGN:

End Standard	EN 1092-3
Remark	Connection: PN16
Min temperature	-10°C
Max temperature	+180°C
Throughput Direction	Straight
End Type	Flanged
Standard	DIN
Material Disc	Brass
Material Body	Bronze
Sub Category	CHECK
Item Number	60-00000040
Category	Valve

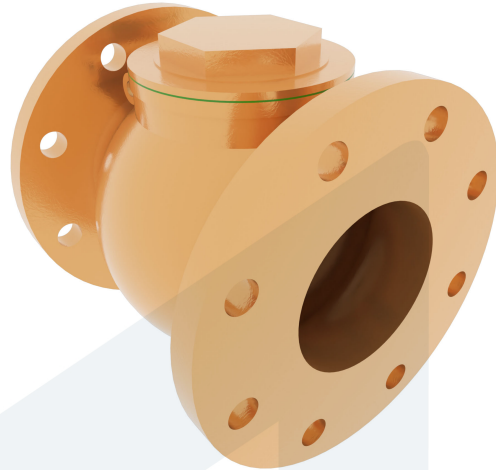

No	Part	Material	Code	Application
5	Pivot	Brass	CW 614N	Boiler feedwater
6	Gasket	Fiber		Cargo oil
7	Disc nut	Brass	CW 614N	Condensate
1	Body	Bronze	CC 491K	Flammable hydraulic oil
2	Cap	Brass	CW 614N	Fuel oil
3	Disc	Brass	CW 614N	Lubricating oil
4	Swing arm	Brass	CW 614N	Sea water
				Water

DN	Pressure Rating Id	nxdd	Hcd	Ø D	L	Kg
100	16	8x18	180	220	220	13

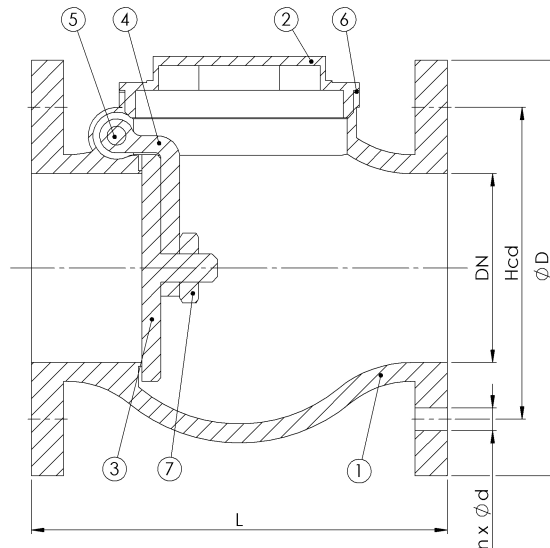
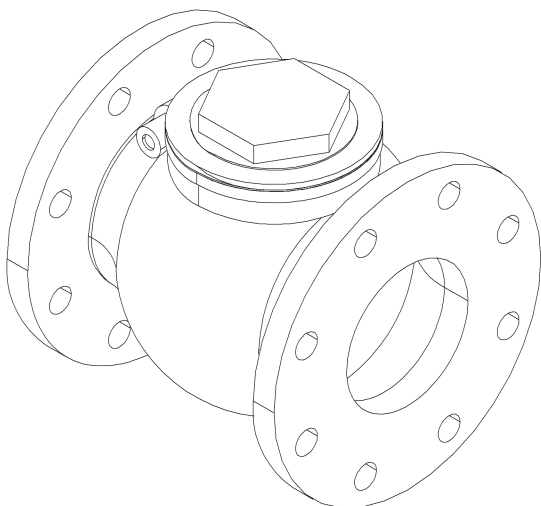

2023-01-04